

ECO PORTABLE SUBMERSIBLE DRAINAGE PUMP “2PED” Series



The ECO PORTABLE SUBMERSIBLE DRAINAGE PUMP "2PED" Series is designed in single Stage Submersible Centrifugal Vertical (Mono Block Type) portable construction , This series pumps are economical cost effective Light weight , easy to handle and easy to use. It comes with both option single phase and three phase connection , This pump is suitable for dewatering , small particale sludge and drain applicaiton with up to 20 mm soild handling size.

Why "HET" make "ECODRAIN"

- >Easy to handle with robust design (Light Weight)
- >Easy to maintain and also repairable multiple time (Not like other imported pump in the market use and throw)
- >Double Mechanical seal set which gives longer life
- >Solid handling size up to 20 mm (Vortex ,Semi Open both design available -as per application)
- > Design with Stainless steel Impeller to maintain long lasting
- >Float switch provided in single phase pump models (optional)
- >Compact size gives liberty to use in small space
- >Plug and play product so, no additional accessories required to start the pump (in three phase pump - panel /starter require, single phase - we provide on/off starter with pump OR **Inbuilt capacitor along with pumpset.**)
- >Pump provided with threaded delivery end for suitable hose connection

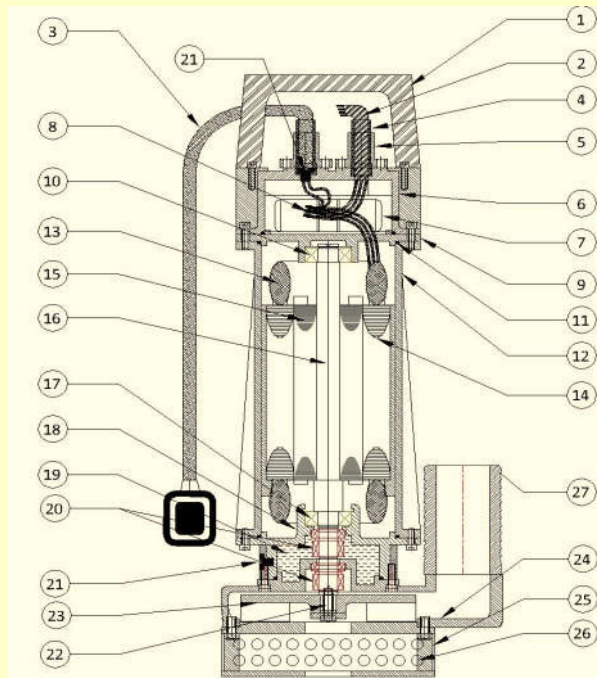

NO.	DESCRIPTION	NO.	DESCRIPTION
1	HANDLE	15	ROTOR DIECAST
2	CABLE	16	ROTOR SHAFT
3	FLOAT SWITCH For 1 - Phase	17	BOTTOM BEARING
4	CABLE PROTECTOR	18	BOTTOM BEARING HOUSING
5	CABLE GLAND	19	OIL
6	TOP COVER	20	MECHANICAL SEAL
7	CAPACITOR For 1 - Phase	21	DRAIN PLUG
8	CABLE JOINT KIT	22	IMPELLER KEY
9	TOP BEARING HOUSING	23	IMPELLER
10	TOP BEARING	24	VOLUTE
11	O' RINGS	25	STAND
12	MOTOR BODY	26	STRAINNER
13	WINDING	27	DELIVERY HOSE
14	STATOR STAMPING		

MATERIALS OF CONSTRUCTION		SPECIAL FEATURES
Top Cover, Base, Brg. Hsg.	Cast Iron / Stainless Steel / Mild steel	1. SPECIAL MOC PROVIDED AS PER CLIENT REQUIREMENT.
Motor Body	Mild Steel / Stainless Steel / Cast Iron	
Impeller	Cast Iron / Stainless	
Shaft	Steel / CF8M	
Hard Ware	S.S.- 400 Series	

APPLICATION		TECH. SPECIFICATION	ACCESSORIES (OPTIONAL)
Mech. Seal Motor Side & Pump Side	SIC/SIC OR TC/TC OR Any As per Requirement.	1. MOTOR - 0.5 KW TO 2.2 KW 2. SPEED - 2900 RPM 3. HEAD - MAX. - 18 MTR.	* Control Panel , Float switch * Hose pipe * Addinational accessories also available
Rubber Part	Nitrile Elstomers	4. DISCHARGE - MAX. 850 LPM 5. SUPPLY-1Ø / 3Ø , 50HZ, AC	OPTIONAL DESIGN FEATURES * Impeller Trim
Spring	Stainless Steel	6. SOLID SIZE- UP TO 20 MM 7. IMPELLER - SEMI/CLOSE TYPE 8. WINDING-"F"/"H"	* Additional Cable length * Change in Material of construction * Optional Hydraulic Design
Surface Treatment	Primer with Epoxy or Air Dry Enamel		
